



KATIKATI YOUTH PARK PROJECT

Sponsorship Proposal

PRESENTED BY:

Katikati Community Led Development



KatikatiYouth

BACKGROUND

Katikati Youth Park: A Youth-Led Vision for the Community

The Katikati Youth Park is a youth-led initiative to transform the existing skate park into a vibrant, welcoming space where young people can feel safe, stay active, and take pride in a place they can call their own.

The Katikati Youth Park project is an example of young people leading the way in shaping their own future.

Driven by the voices of local youth, this initiative has emerged from extensive engagement and workshops throughout 2024 and early 2025, where young people identified their needs, aspirations, and priorities. Their message was clear—**they want a space of their own, a place to play, connect with friends, and feel safe.**

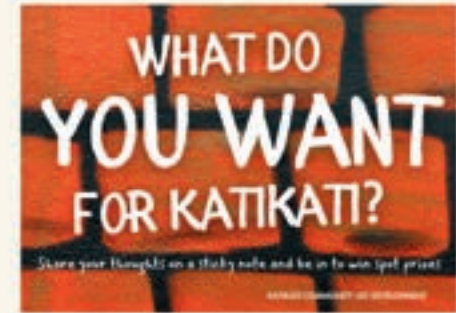

Community-led development (CLD) in Aotearoa is about empowering local people to drive change, and in Katikati, young people are at the heart of this transformation. The Katikati Community Led Development Steering Group, established in late 2023, has facilitated this process, ensuring that the insights and solutions proposed by youth are supported and put into action

During consultations, youth emphasised that **revitalising the Katikati Skate Park was essential to meeting their need for a dedicated space where they could gather, be active, and feel a sense of belonging.**

The Katikati Youth Park project is a direct response to what young people have asked for. The Katikati Youth Park will provide a safe space for young people to gather, as well as seating and cover for parents and caregivers, play equipment for younger siblings, and BBQ facilities for shared meals.

The existing skate park, originally developed in 2012 with a second phase completed in 2014, has served the community well. However, it now shows signs of wear and lacks key facilities that could make it a more inviting space for all. **With no shade, limited toilet facilities, and no seating or BBQ areas, young people have called for improvements**—and now, youth are taking action to make it happen.

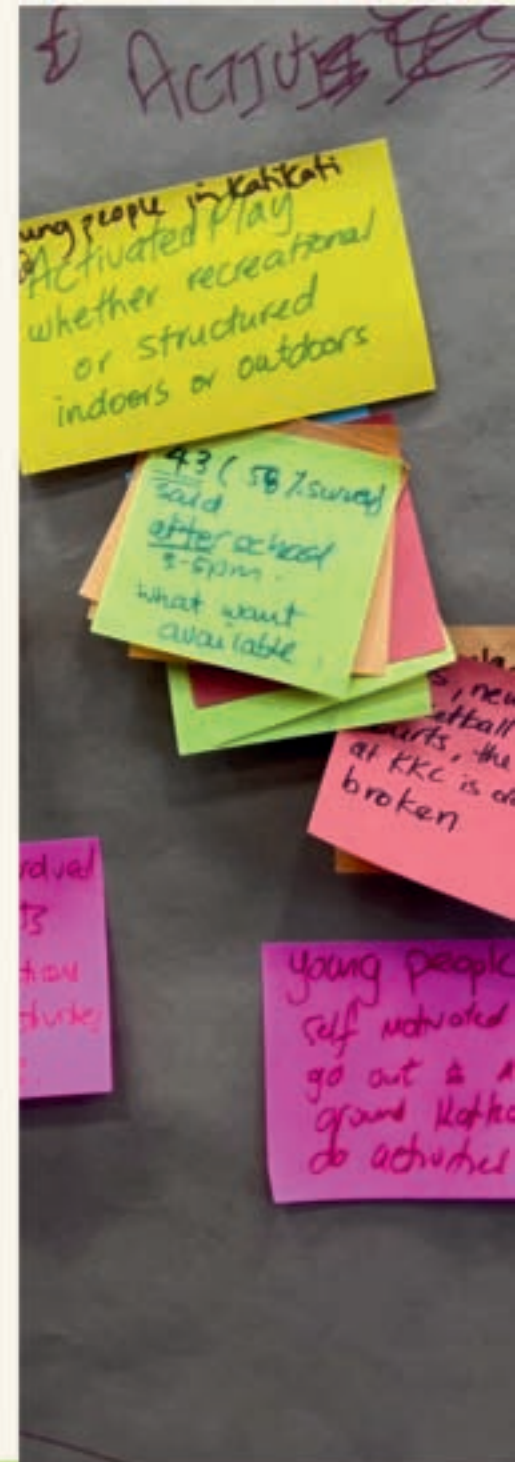

Young leaders are working alongside the Steering Group to organise fundraising events, develop sponsorship proposals, and connect with local businesses and community members for support.

This is an opportunity for the entire Katikati community to get behind its young people and support their vision.

Local businesses, organisations, and individuals can contribute by sponsoring specific equipment or making a general donation to the project.

Every contribution, big or small, helps empower our youth and creates a space for youth to play, connect with friends, and feel safe.



The upgraded park will be delivered in three stages and include new seating, BBQ facilities, a flying fox, climbing nets, sensory play equipment, basketball court, and much more.

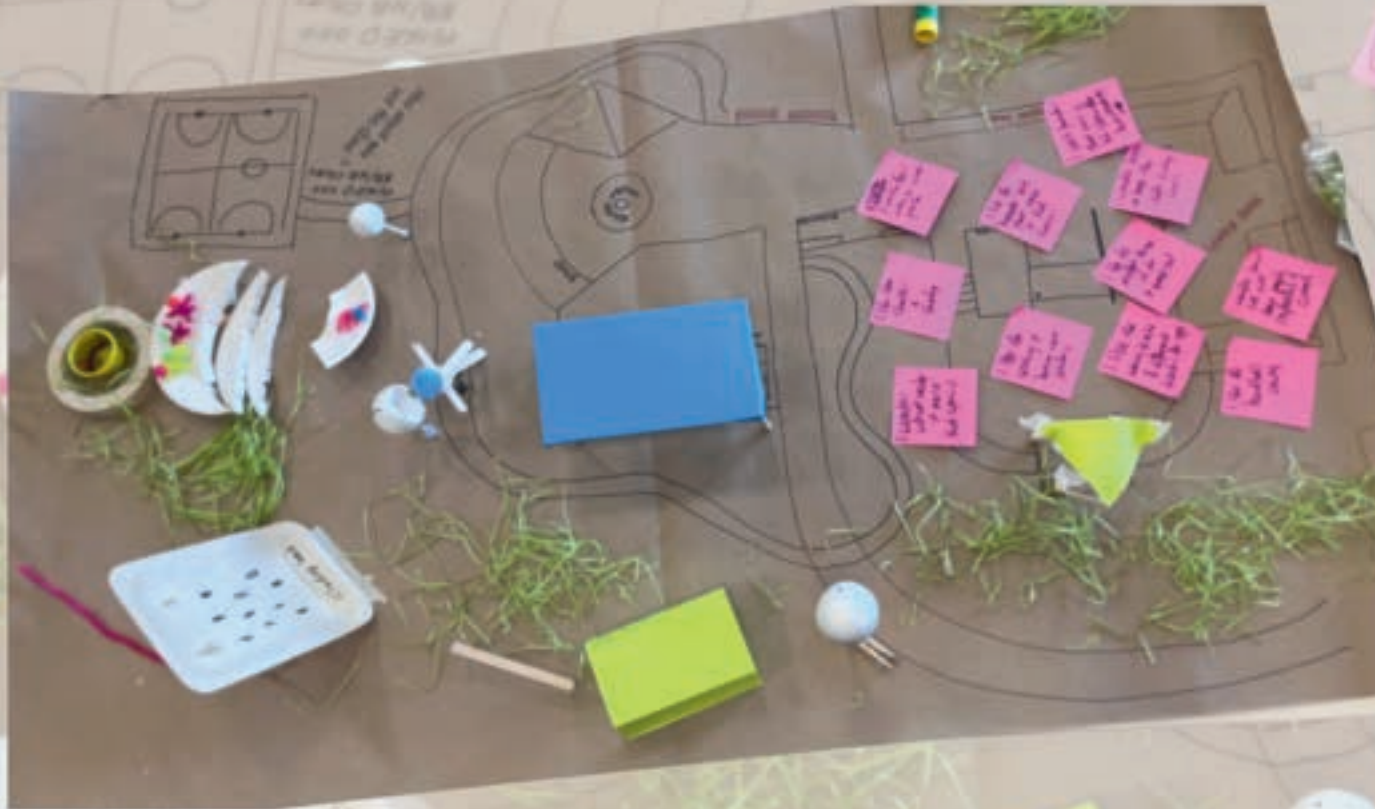

Project Overview



Total Budget: \$129,000+GST

Delivery Phases:

Stage 1: BBQ, picnic tables, seating, canopy cover – \$30,885

Stage 2: Playground equipment, flying fox, climbing structures – \$53,086

Stage 3: Half-court basketball area with fencing – \$45,000

(Pump track planned for future funding)

Sponsorship Packages

We are now inviting local businesses, organisations, and individuals to become part of this exciting journey by sponsoring part of the project—either through financial support or in-kind contributions.

Sponsorship opportunities range from general donations to naming rights for specific park features and can be customised to suit any budget.



Ways to Sponsor

1. Choose a Sponsorship Tier, customisable to suit your budget

| Level | Contribution | Recognition & Benefits |
|----------------------------|-----------------|--|
| Platinum | \$10,000+ | Naming rights to a park feature, video feature, VIP ribbon cutting, logo on signage |
| Gold | \$5,000–\$9,999 | Logo on park signage, feature in launch event, recognition on website and social media |
| Silver | \$2,000–\$4,999 | Name/logo on donor board, “Thank You” artwork by youth, social media shoutout |
| Bronze | \$500–\$1,999 | Name on donor board, newsletter and social media thanks |
| Community Supporter | \$50–\$499 | Name included on donor board |

All levels can be fulfilled through cash or in-kind support (materials, labour, services).

2. Sponsor a Specific Feature

| Item | Cost (excl. GST) | Sponsor Recognition |
|--------------------------|------------------|---|
| Double flying fox | \$24,000 | Naming rights + signage |
| BBQ unit | \$19,995 | BBQ by [Your Business] signage |
| Timber Seating x2 | \$1,500 | Name on donor board, newsletter and social media thanks |
| BBQ Roof Cover | \$3,000 | Name/logo on donor board, social media shoutout |
| Picnic table x2 | \$2,380 (each) | Name/logo on donor board, social media shoutout |
| Basketball half court | \$45,000 | Court naming rights + signage |
| Spider web climbing net | \$2,466 | Name/logo on donor board, social media shoutout |
| Cargo Net Climbing Frame | \$8,550 | Sponsor signage on poles |

We welcome full or partial sponsorships, and co-branded sponsorships between families or businesses

2. Sponsor a Specific Feature.. continued

| Item | Cost (excl. GST) | Sponsor Recognition |
|---------------------------------|---|---|
| Climbing Platform - multi level | \$2,000 | Name/logo on donor board, social media shoutout |
| Double Slide | \$2684 | Name/logo on donor board, social media shoutout |
| Double Bay Log Swing Structure | \$9,015 +installation | Sponsor signage on poles |
| Sensory musical play set | \$2684 (Xylophone) \$4315 (Percussion play sets) | Name/logo on donor board, social media shoutout |
| Sunshade canopy | \$5,000 | Sponsor signage on poles |
| Tilt Bin | \$1630 | Name on donor board, newsletter and social media thanks |

We welcome full or partial sponsorships, and co-branded sponsorships between families or businesses

Examples of Features



Combination BBQ,
picnic tables, seating
under canopy



Climbing platforms



Double BBQ



Double slide



Combination
multi swing
structure



Sensory play items



Pump cycle/skateway



Spider web climbing structure



'Half court' basketball court



Flying fox structure

Why Sponsor?

- **Show your support** for youth wellbeing and local development
- **Promote your brand** in a highly visible, positive community setting
- **Demonstrate leadership** in community investment and youth empowerment
- **Leave a legacy** in a project that will benefit generations



Get Involved

Join us in making the Katikati Youth Park a reality

CONTACT US TO DISCUSS SPONSORSHIP OPTIONS:

Katikati Community Led Development

Email: info@KatikatiCLD.nz

Phone: 021 02345 276

